

model

# 30510

## ROPE TENSION LOAD CELL

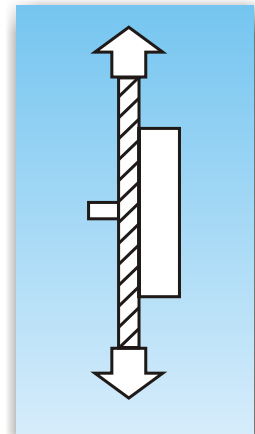
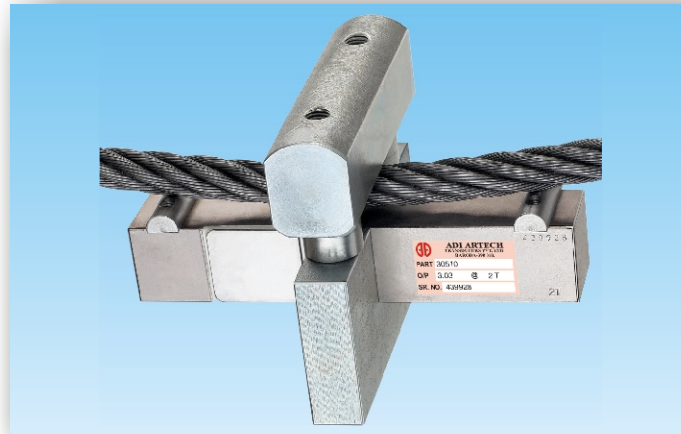

### FEATURES :

- ❖ 0.5 Tf to 7.5 Tf capacities load cells are offered for rope tension ranging from 1Tf to 50 Tf
- ❖ Complete environmental protection IP-65 class.
- ❖ Standard output 1.0mV/V available
- ❖ can be provided to accommodate multirope applications - up to 4 ropes

### APPLICATIONS :

- ❖ Elevator load monitor.
- ❖ Specially designed for protecting cranes and hoists from overload.
- ❖ Tension measurement in stay ropes, suspension ropes and railway catenary ropes.
- ❖ Vehicle pull test.
- ❖ Ship Bollard pull test.

### DESCRIPTION :

- ❖ This is used in industrial applications where the tension in wire rope needs to be carefully and continuously monitored and prevent overload.
- ❖ The load cell is conveniently clamped-on to the rope in existing condition.
- ❖ Designed to handle rope dia from 8mm to 80mm.

### PERFORMANCE SPECIFICATION :

<b>Standard Capacities (Tf.)</b>	: 0.5,1,2,3,5,7.5
<b>Excitation Voltage</b>	: 10 VDC - Maximum 15 VDC
<b>Nominal Output</b>	: 1 mV/V
<b>Non - Linearity</b>	: < ± 5.0 % FSO for range upto 20% < ± 2.0 % FSO for range above 20%
<b>Hysteresis</b>	: < ± 0.1 % FSO (Full Scale Output)
<b>Non-Repeatability</b>	: < ± 0.1% FSO
<b>Creep (30 minutes)</b>	: < ± 0.03 % FSO
<b>Input Resistance</b>	: 390 Ohms
<b>Output Resistance</b>	: 350 Ohms
<b>Insulation Resistance (50V)</b>	: > 1000 Mega Ohms
<b>Cable Length (4 core)</b>	: Upto 2T-5 M, Above 2T-10M
<b>Safe Overload</b>	: 150 % of Rated Capacity
<b>Ultimate Overload</b>	: 300 % of Rated Capacity
<b>Temp. Compensated Range</b>	: 0-60 °C
<b>Temp. Effect on Output</b>	: < 0.005 % FSO/ °C
<b>Temp. Effect on Zero</b>	: < 0.005 % FSO/ °C
<b>Deflection</b>	: < 0.5 mm at FSO
<b>Material of Construction</b>	: Tool Steel
<b>Environmental Protection Class</b>	: IP65



**ADI ARTECH**  
TRANSDUCERS PVT. LTD.

A Joint venture with  
ARTECH INDUSTRIES INC., U.S.A.

**ELECTRICAL TERMINATION**

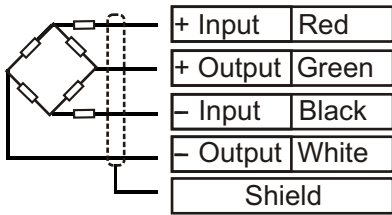

4 CORE SCREENED CABLE

Rope Tension (Tons)	Recommended Load Cell Capacity (Tons)	Rope dia - D	A	B	C	E
1,2,5	0.5	8-16	32	32	172	7.5
5,10	1	24-36	32	32	172	7.5
15	2	up to 40	32	32	172	7.5
25	3	up to 60	38	38	228	7.5
40	5	up to 72	38	38	228	7.5
50	7.5	up to 80	50	50	300	7.5

All dimensions are in mm.

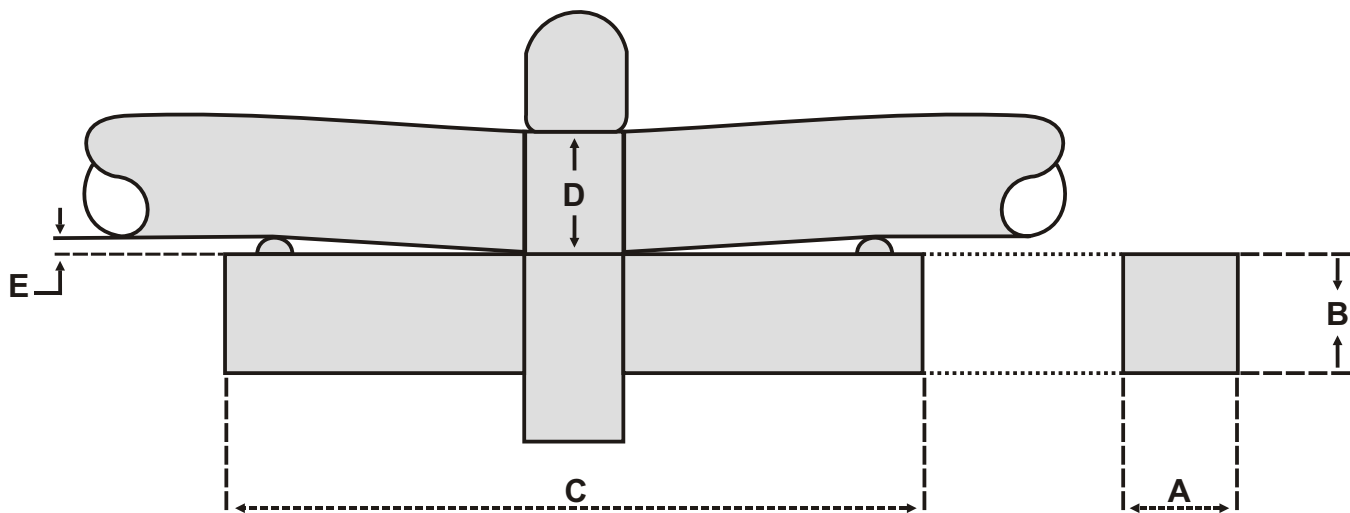

**ORDER INFORMATION :**

**ADI ARTECH** is dedicated in maintaining adequate inventories of its Load Cells to provide the best service in the industry.

Order by the model number and indicate the capacity required.

Specifications are subject to change without notice

	Manufactured by :	917/1, G.I.D.C. ESTATE, MAKARPURA, VADODARA - 390 010 (INDIA)
	<b>ADI ARTECH</b>	Phone : 2655083/2651023
	<b>TRANSDUCERS PVT. LTD.</b>	FAX : (91) 0265-2638751
	A Joint venture with ARTECH INDUSTRIES INC., U.S.A.	E-mail : sales@adiartech.com artechad1@sancharnet.in
		Website : www.adiartech.com

**QUALITY \* PERFORMANCE \* SERVICE**  
**“A PREFERRED NAME IN LOAD CELL TECHNOLOGY”**