

model

# 90610-B

## PANCAKE COMPRESSION LOAD CELL

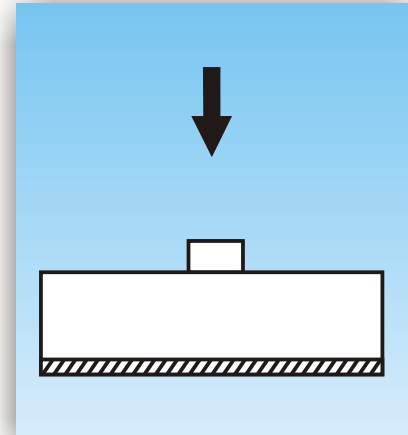

### FEATURES :

- ❖ 50Kgf to 50Tf Capacities.
- ❖ Complete environmental protection IP68 class.
- ❖ Standard output 2.0 mV/V available.
- ❖ Hardened stainless steel construction.
- ❖ Miniature and low profile.
- ❖ Easy for installation.
- ❖ Custom built design available on request

### APPLICATIONS :

- ❖ Tank level measurement.
- ❖ Weighbridge.
- ❖ Tank, silo.
- ❖ Tensile testing and automation.
- ❖ Force and impact test.
- ❖ Low profile floor scale.

### DESCRIPTION :

- ❖ 90610 -B pancake compression load cells are suitable for weigh bridge, tank and hopper weighing applications.
- ❖ This is constructed from heat treated stainless steel suitable for harsh and hygienic industrial applications.
- ❖ It is hermetically sealed and it has long life.
- ❖ Extremely suitable for tank, silos level monitoring.
- ❖ 90610 -B is available with integral load button.

### PERFORMANCE SPECIFICATION :

<b>Standard Capacities (Kgf.)</b>	: 50,100,200,500
<b>(Tf.)</b>	: 1,2,3,5,10,20,30,50
<b>Excitation Voltage</b>	: 10 VDC - Maximum 15 VDC
<b>Nominal Output</b>	: 2.0 mV/V
<b>Non - Linearity</b>	: < ± 0.05 % FSO (Full Scale Output)
<b>Hysteresis</b>	: < ± 0.05 % FSO
<b>Non-Repeatability</b>	: < ± 0.05 % FSO
<b>Creep (30 minutes)</b>	: < ± 0.03 % FSO
<b>Input Resistance</b>	: 770 ± 20 Ohms 2T & Above 390 ± 10 Ohms Upto 1T
<b>Output Resistance</b>	: 770 ± 7 Ohms 2T & Above 350 ± 3 Ohms Upto 1T
<b>Insulation Resistance (50V)</b>	: > 1000 Mega Ohms
<b>Cable Length (4 core)</b>	: Upto 2T-3M, Above 2T-5M
<b>Safe Overload</b>	: 150 %
<b>Ultimate Overload of Rated</b>	: 300 %
<b>Temp. Compensated Range</b>	: 0-60 °C
<b>Temp. Effect on Output</b>	: < 0.005 % FSO/ °C
<b>Temp. Effect on Zero</b>	: < 0.005 % FSO/ °C
<b>Deflection</b>	: < 0.5 mm at FSO
<b>Material of Construction</b>	: Stainless Steel-17-4 PH
<b>Environmental Protection Class</b>	: IP68



**ADI ARTECH**  
TRANSDUCERS PVT. LTD.

A Joint venture with  
ARTECH INDUSTRIES INC., U.S.A.

**ELECTRICAL TERMINATION**

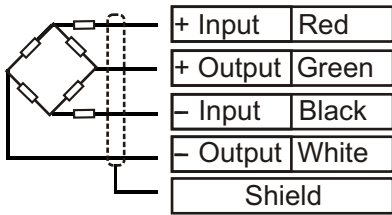

4 CORE SCREENED CABLE

Capacity	A	B	C	D	E	F	G	H	J
50kg - 1T	50	30	13	23	7	42	150	M4x0.7	6
2T - 5T	90	48	25	35.5	12.5	70	150	M6x1	8
10T - 20T	115	60	32	47.5	12.5	90	150	M8x1.25	10
30T - 50T	155	90	44	74.5	15.5	125	150	M12x1.5	14

All dimensions are in mm.

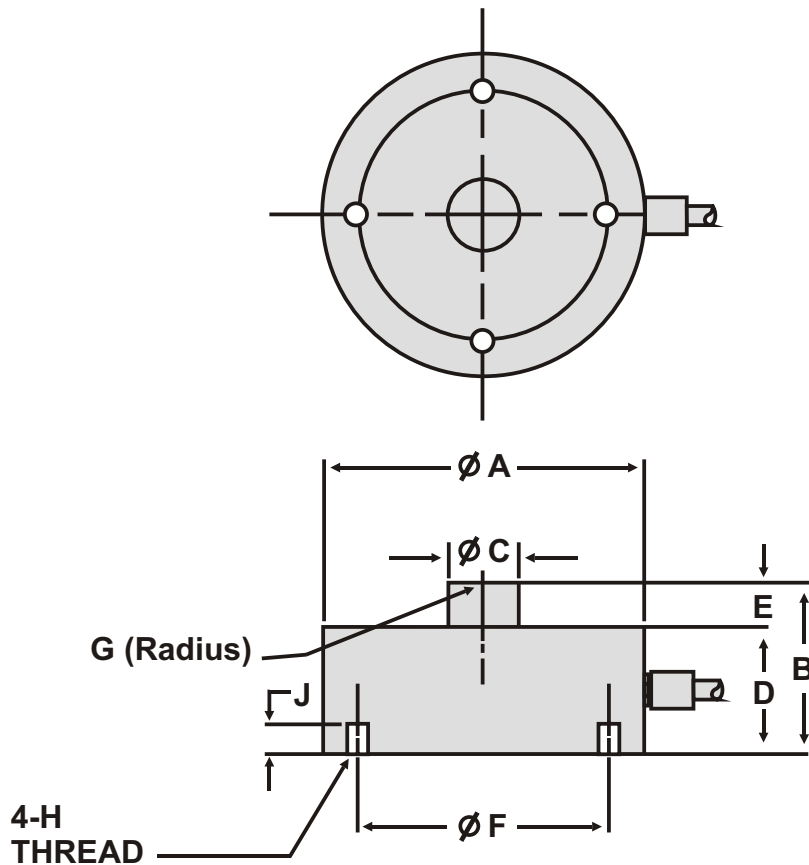

**ORDER INFORMATION :**

**ADI ARTECH** is dedicated in maintaining adequate inventories of its Load Cells to provide the best service in the industry.

Order by the model number and indicate the capacity required.

Specifications are subject to change without notice

	Manufactured by :	917/1, G.I.D.C. ESTATE, MAKARPURA, VADODARA - 390 010 (INDIA)
	<b>ADI ARTECH</b>	Phone : 2655083/2651023
	<b>TRANSDUCERS PVT. LTD.</b>	FAX : (91) 0265-2638751
	A Joint venture with ARTECH INDUSTRIES INC., U.S.A.	E-mail : sales@adiartech.com artechad1@sancharnet.in
		Website : www.adiartech.com

**QUALITY \* PERFORMANCE \* SERVICE**  
**“A PREFERRED NAME IN LOAD CELL TECHNOLOGY”**