

**Description**

**CE Certified** TTS-SQ Torque Sensor used in industrial & research application where Torque is to be measured accurately. It is easily fitted in suitable test bench through Square Drive ends-male/female. It is constructed from stainless steel 17-4 PH material for ruggedness and harsh industrial applications. Its design is strain gage based with full temperature compensation over 10 to 50°C range.

**Features**

- ❖ **CE Rated** ❖ Excellent selection of range from 0-10 to 0-50KNM.
- ❖ S.S. 17-4 PH construction for resistance against shock and overload.
- ❖ Complete Environmental Protection -IP65 class.
- ❖ Can be customized to suit customer's requirements.
- ❖ Axial & Bending force are compensated.

**Applications**

- ❖ Motor, Switches, Shaft & Axle torque measurement.
- ❖ To measure operating Torque of Industrial Valve & actuators.
- ❖ Automotive, Aerospace & offshore valves test rigs.
- To measurement tightening Torque of Industrial Fasteners.

**Performance Specification**

Standard Capacities(NM)	10, 20, 50, 100, 200, 300, 500, 1K, 1.5k, 2K, 3K, 5K, 10K, 20K, 30K, 50K
Excitation Voltage	10 VDC- Maximum 15 VDC
Nominal Output	2.0 m V/ V +/- 0.5
Non - Linearity	< ±0.1%FSO(Full Scale Output)
Hysteresis	< ±0.1% FSO
Non-Repeatability	< ±0.1% FSO
Creep (30 minutes)	< ±0.3% FSO
Zero Balance	±1.0% FSO
Input Resistance	392 ± 15 Ohms
Output Resistance	350 ± 3 Ohms
Insulation Resistance (50 VDC)	> 1000 Mega Ohms
Cable Length (4 Core Screened)	5 mtrs
Safe Overload of Rated Capacity	150%
Ultimate Overload of Rated Capacity	250%
Allowable Side Load	50%
Temp. Compensated Range	10-50 °C
Temperature Effect on Output	< 0.05% FSO/ °C
Temperature Effect on Zero	< 0.05% FSO/ °C
Rotational Angular Deflection	< 0.4mm at FSO
Finish & Construction	Stainless Steel 17-4 PH
Environmental Protection Class	IP 65 for gage area

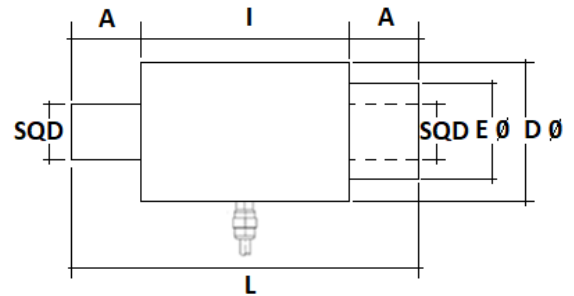
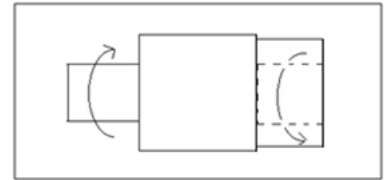

**Electrical Termination**

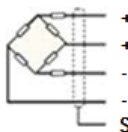

- + Input - Red
- + Output - Green
- Input - Black
- Output - White
- Shield - Floated

**Options**

- 4-20 mA / 0-2 Volt Output
- Digital Version with RS-485 interface / USB output
- Blue Tooth Or Wireless Telemetry
- Compatible Instrument
- Software for Graphic, Tabulation, Reporting And Analysis

Capacity NM	A	D-appx.	I	E - appx.	L	SQ
10, 20, 50, 100	15	33	40	32	70	12.7(1/2")
200, 300, 500	25	47	60	50	110	19.1(3/4")
1K, 1.5K	30	55	80	50	140	25.4(1")
2K, 3K, 5K	40	72	95	70	175	38.1(1 1/2")
10K	55	118	110	115	220	63.5(2 1/2")
20K, 30K	70	142	130	140	270	76.2(3")
50K	80	182	170	180	330	88.9(3 1/2")

Specifications are subject to change.

All dimensions are in mm.



Made in INDIA by:

**ADI ARTECH**  
**TRANSDUCERS PVT. LTD.**  
 (An ISO 9001:2015 Certified Company)

917/1, G.I.D.C. Estate, Makarpura, Vadodara - 390 010, Gujarat, INDIA  
**Mobile** : +91-9374068998, 9879444551, 9054467370  
**Email** : sales@adiartech.com, adiartech@adiartech.com  
**Website** : www.adiartech.com