

Description

CE Certified Ultra Precision Strain Gage based 20510 Crane Load Cell is versatile, compact and rugged. It is used for tension measurements, Crane weighing. It is used in tension mode only. Tension Loading can be done with Dee / Bow Shackle & Hook. It is available in 3 Tf to 20 Tf capacities. Higher capacity can be offered.

Features

- ❖ **CE Rated** ❖ Standard 3, 5, 7.5, 10, 15, 20, 30 TF Capacities available.
- ❖ High Alloy Tool Steel construction for resistance against shock and overload.
- ❖ Perpendicular holes design helps in minimizing external moments effects and improves safety & accuracy.
- ❖ It is light weight and portable.
- ❖ High Temperature version for foundry applications is available upon request.
- ❖ Can be designed for higher capacities and to fit your dimensional needs.

Applications

- ❖ To measure rope tension by inserting as a link in to the line.
- ❖ To measure towing force of the vehicles and Ships.
- ❖ Force Measurement Tension Dynamometer.
- ❖ Hanging & Crane Scale.
- ❖ Material handling equipments. →Cargo handling in Ship Yards.

Performance Specification

Standard Capacities	3, 5, 7.5, 10, 15, 20, 30 TF.
Excitation Voltage	10 VDC- Maximum 15 VDC
Nominal Output	1.0 m V/ V
Non - Linearity	< ±0.15% FSO
Hysteresis	< ±0.05% FSO
Non-Repeatability	< ±0.025% FSO
Creep (30 minutes)	< ±0.05% FSO
Zero Balance	±1.0% FSO
Input Resistance	780 ± 15 Ohms
Output Resistance	700 ± 3 Ohms
Insulation Resistance (50 VDC)	> 1000 Mega Ohms
Cable Length (4 Core Screened)	10 Mtrs
Safe Overload of Rated Capacity	150%
Ultimate Overload of Rated Capacity	200%
Temp. Compensated Range	0-60 °C
Temperature Effect on Output	< 0.0025% FSO/ °C
Temperature Effect on Zero	< 0.004% FSO/ °C
Deflection	< 0.4 mm at FSO
Finish & Construction	Electroless Nickel Plated EN24-44HRS

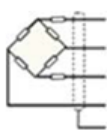
Electrical Termination	Options
 <ul style="list-style-type: none"> + Input - Red + Output - Green - Input -Black - Output - White Shield - Floated 	<ul style="list-style-type: none"> * Compatible Instruments with Relay output, 4-20 mA or 0-2 Volt Output * Digital Version with RS-485 interface / USB output / Blue Tooth Telemetry / Wireless Telemetry * Software for Graphic, Tabulation and Reporting * Customization with customers dimensions

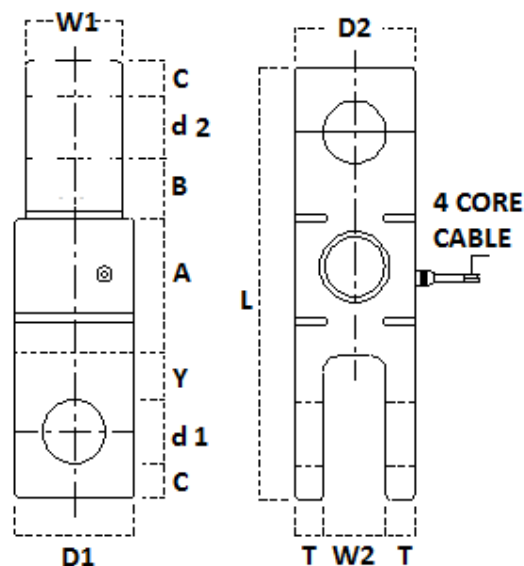

CAP. TF	L	D1/D2	W1	W2	T	d1/d2	C	B	A	Y	Suggested Shackle-Crosby Or equivalent	Suggested Hook-Crosby , Sea Linkes Or equivalent
3	200	40/50	25	20	15	21/21	12.5	15	78	40	G-2130-3.25T	S-1327-4T,SL-320ALOY-3T
5	240	52/55	30	23	16	23/26	16	15	94	50	G-2130-4.75T,6.25T	S-1327-6.8,SL-320ALOY-5T
7.5,10	290	62/75	50	32	21.5	32/36	20	24	103	55	G-2130-12T	S-1327-10T,SL-320ALOY-11T
15,20	350	75/90	58	42	24	40/42	24	30	120	70	G-2130-17T,G-2140-30T	S-1327-20T,SL-320ALOY-22T
30	365	110/110	63	60	25	60/60	30	38	103	44	G2130-35T	S-1327-27TSL-320ALOY-30T

Specification are subject to change.

All dimensions are in mm.

	<p>Made in INDIA by:</p> <p>ADI ARTECH</p> <p>TRANSDUCERS PVT. LTD.</p> <p>(An ISO 9001:2015 Certified Company)</p>	<p>917/1, G.I.D.C. Estate, Makarpura, Vadodara - 390 010, Gujarat, INDIA</p> <p>Mobile : +91-9374068998, 9879444551, 9054467370</p> <p>Email : sales@adiartech.com, adiartech@adiartech.com</p> <p>Website : www.adiartech.com</p>
--	---	---